

# THE 2100-SRT

## STRETCH WRAP MACHINE

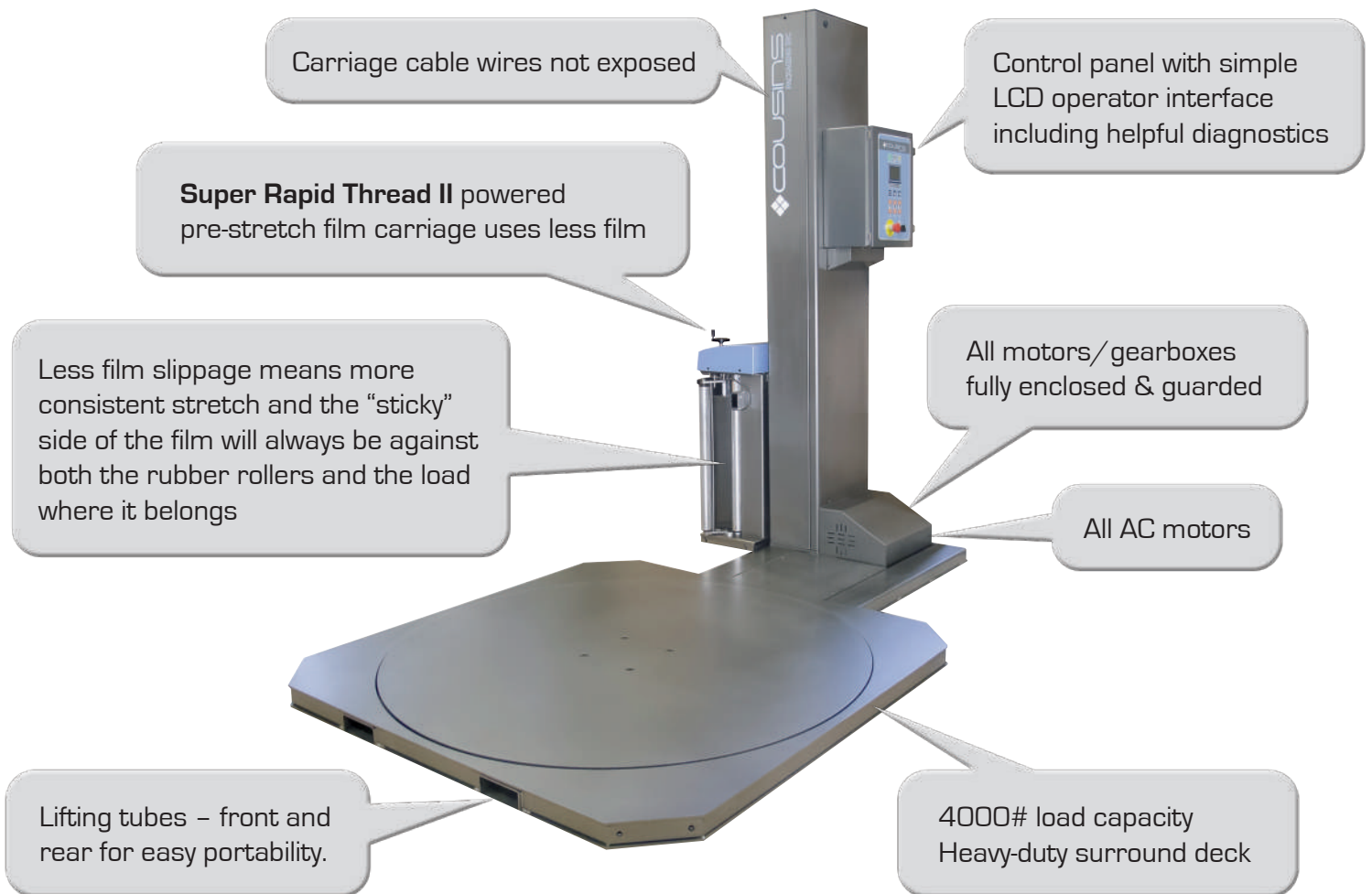

**Built in North America with Brand Name Components.**  
**The 2100-SRT has Features & Benefits that Surpass the Competition.**

- ❖ Affordable and simple with more standard features than any other pallet wrapper in this price range.
- ❖ A quality machine built with quality components and supported by a local qualified distributor.

We invite you to go online at [www.newwaypkgshop.com](http://www.newwaypkgshop.com) for more information or call 800.456.3929

# 2100-SRT DESIGN FEATURES/SPECIFICATIONS

## LOAD CAPACITY:

- ❖ 50" L x 50" W x 80" H
- ❖ 4000# turntable capacity
- ❖ **NOTE:** Larger load size options are available.

## CONTROLS:

- ❖ LCD Operator Interface with Diagnostics
- ❖ Cycle Pause & Reinforce Wrap
- ❖ Separate UP/DOWN Spiral Speed Controls
- ❖ NEMA 12 with Emergency Stop Button
- ❖ 3 Separate Wrap Programs
- ❖ Selectable Reduced Film Tension parameters for wrapping top and/or bottom of light loads
- ❖ 115 Volts 1 Phase 60 Hz 15 Amps
- ❖ **3 Year Warranty on Components**

## FILM CARRIAGE:

- ❖ Super Rapid Thread II™ 20" capacity pre-stretch film carriage
- ❖ Safety Door with auto power cut-off switch
- ❖ Special Film Threading Device - Uniquely orientates the sticky side of the film against the pre-stretch rollers and the inside on the load.
- ❖ ½ HP AC variable speed motor
- ❖ 33% to 313% fixed stretch capability
- ❖ Carriage Descent Safety Shut-Off Device
- ❖ Superior film-to-roller contact area
- ❖ **Lifetime warranty on pre-stretch rollers**

## TOWER DESIGN:

- ❖ Fully Enclosed & Guarded Motors
- ❖ No Exposed Cables
- ❖ Heavy Duty Formed/Structural Steel
- ❖ Electro-static powder coated paint finish
- ❖ **5 Year Warranty on Steel Fabrications**

## TURNTABLE:

- ❖ 4000# capacity with Heavy Duty Surround deck
- ❖ 1 - 12 RPM with Soft Start Acceleration
- ❖ ½ HP AC Variable Speed Drive
- ❖ Forklift Tubes - Front and Rear
- ❖ Maintenance Free 42 Support Wheels
- ❖ 57" diameter
- ❖ Optional loading ramp 60" long x 48" wide complete with 10" level porch area available

